



11 Boundary Road Heathcote NSW

4 2 1

Privately nestled within a quiet and peaceful location, this spacious and beautifully presented four-bedroom, two-bathroom family home is set in a tranquil, leafy environment within an elevated setting that provides the perfect balance of comfort, privacy, and convenience with peaceful views over the Royal National Park. As you enter this light-filled home, you'll immediately notice the welcoming atmosphere created by its open-plan design. Recently renovated throughout, the spacious living and dining areas flow seamlessly to the modern stone kitchen and family room, with grassy backyard beyond, offering plenty of space for family gatherings and entertaining. The thoughtful layout offers generous bedroom sizes and separate living zones to ensure plentiful space for modern family living. Perched on a quiet and peaceful plot of 746.1

Type : House
Land Size : 746.1 sqm
View : <https://www.mitchellestateagents.com.au/8244449>

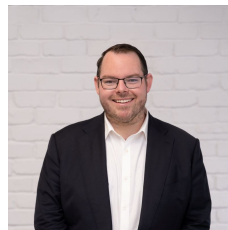

James Mitchell
0405 951 570

[For full version visit the website](https://www.mitchellestateagents.com.au)

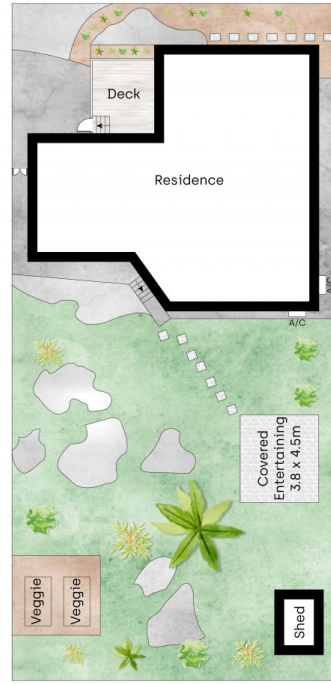

0 1 2 3 4 5 METRES

4 2 1

Whilst bwrn.com.au has made every attempt to ensure the accuracy of the floor plan contained here, measurements are approximate and no responsibility is taken for any error, omission, or mis-statement. This plan is for illustrative purposes only.

11 Boundary Road, Heathcote

Mitchell Estate Agents