



4/33 Wills Road Woollooware NSW

1 1 1

Perfectly situated in the heart of North Woollooware, this charming and welcoming unit offers modern, low maintenance living in an ultra-convenient locale only moments to local amenities, Woollooware train station and Cronulla's glistening coastline. With light-filled interiors including high ceilings, updated finishes, and a cozy easy-care floorplan, this sunlit home is the perfect choice for residents seeking both a private space and lifestyle convenience with easy access to local cafes, transport and central Cronulla.

Features include:

- Open plan living and dining with peaceful elevated outlook, split-system air conditioning

[For full version visit the website](https://www.mitchellestateagents.com.au/8208)

Type : Apartment
Land Size : 60 sqm
View : <https://www.mitchellestateagents.com.au/8208>

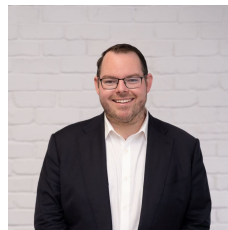

James Mitchell
0405 951 570



Car Space
2.7 x 6.2m

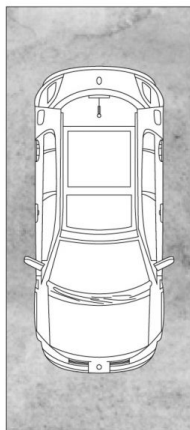

[Not In Position]

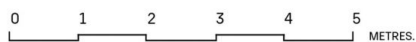
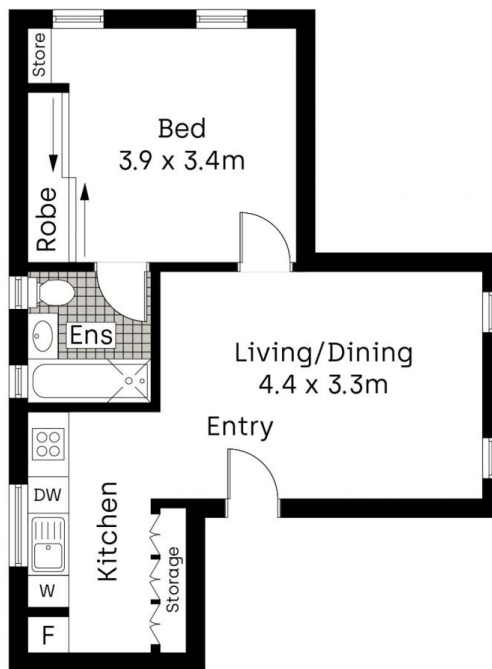

Whilst bwrn.com.au has made every attempt to ensure the accuracy of the floor plan contained here, measurements are approximate and no responsibility is taken for any error, omission, or mis-statement. This plan is for illustrative purposes only.

4/33 Wills Road, Woollooware

Mitchell Estate Agents