



## 11 Swallow Rock Drive Grays Point NSW

3  2  2 

Peacefully placed amongst the treetops, and embracing elevated views towards the Port Hacking River and Royal National Park, this private oasis offers an extraordinary blend of nature, modern functionality and architectural interest. Situated with handy access via a private driveway, the home is secluded and delivers a versatile, split-level floorplan taking full advantage of the expansive views. Featuring open-plan living and dining spaces, updated kitchen with quality appliances and substantial bedroom accommodation, the home is located in close proximity to Swallow Rock Reserve and boat ramp, local village shops, Grays Point Public School and Kirrawee High School catchment.

Features include:

[For full version visit the website](#)

**Type** : House

**View** : <https://www.mitchellestateagents.com.au/8167235>

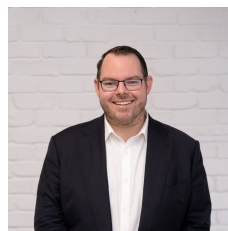

**James Mitchell**  
0405 951 570

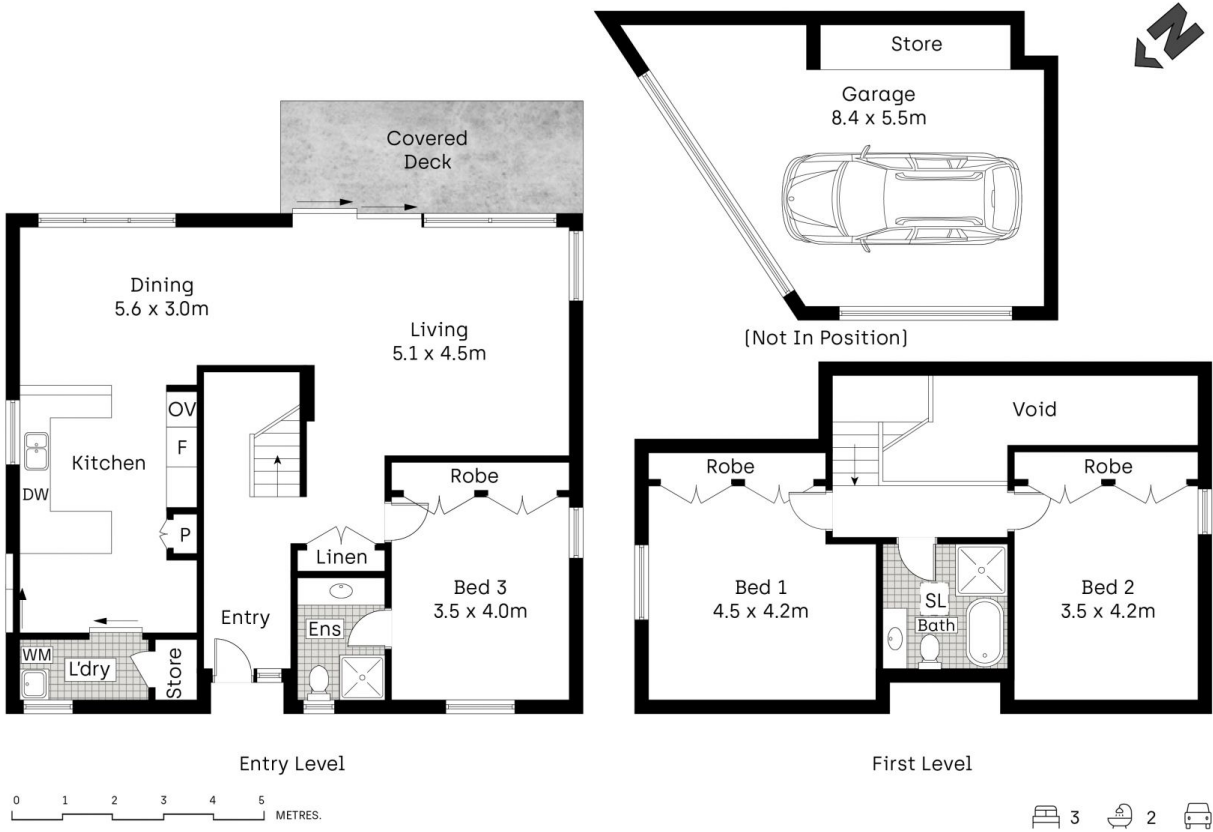

Whilst bwrn.com.au has made every attempt to ensure the accuracy of the floor plan contained here, measurements are approximate and no responsibility is taken for any error, omission, or mis-statement. This plan is for illustrative purposes only.

11 Swallow Rock Drive, Grays Point

**Mitchell** Estate Agents